



**Solon Road, Brixton, SW2**

2 bedroom flat to let

**£496 Per Week**

Furnished

## Property Details

A beautiful, bright and open two double bedroom flat with a stunning balcony - situated around a sixteen minute walk from Clapham Common station. This spacious middle floor Victorian two double bedroom flat is located on one of the lovely residential streets in the Victorian pocket between Brixton and Clapham North. The flat has two good size double bedrooms, one of which has the added benefit of access to the private roof terrace which overlooks the skyline of London. The bedrooms share a bright, spacious family size bathroom. To top this wonderful property off there is a modern spacious open plan kitchen reception room. The flat is ideally located with excellent transport links into the city and the area's plethora of entertainment options including great pubs, shops, bars, and the popular Clapham Common.

## Features

- Two bedroom
- Open Plan
- Victorian
- Close to central Brixton
- Good transport links
- Bright and airy
- Roof terrace

Council tax band C      EPC rating C (73)





Solon Road, Brixton, SW2

## Solon Road

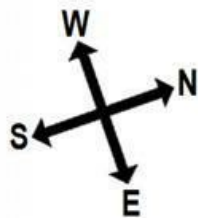

2 bed flat.

Approx internal area:

486sqft 45sqm

While we do try our very best, floor plans are produced as a guide only and we take no responsibility for the precise accuracy with which any property is represented

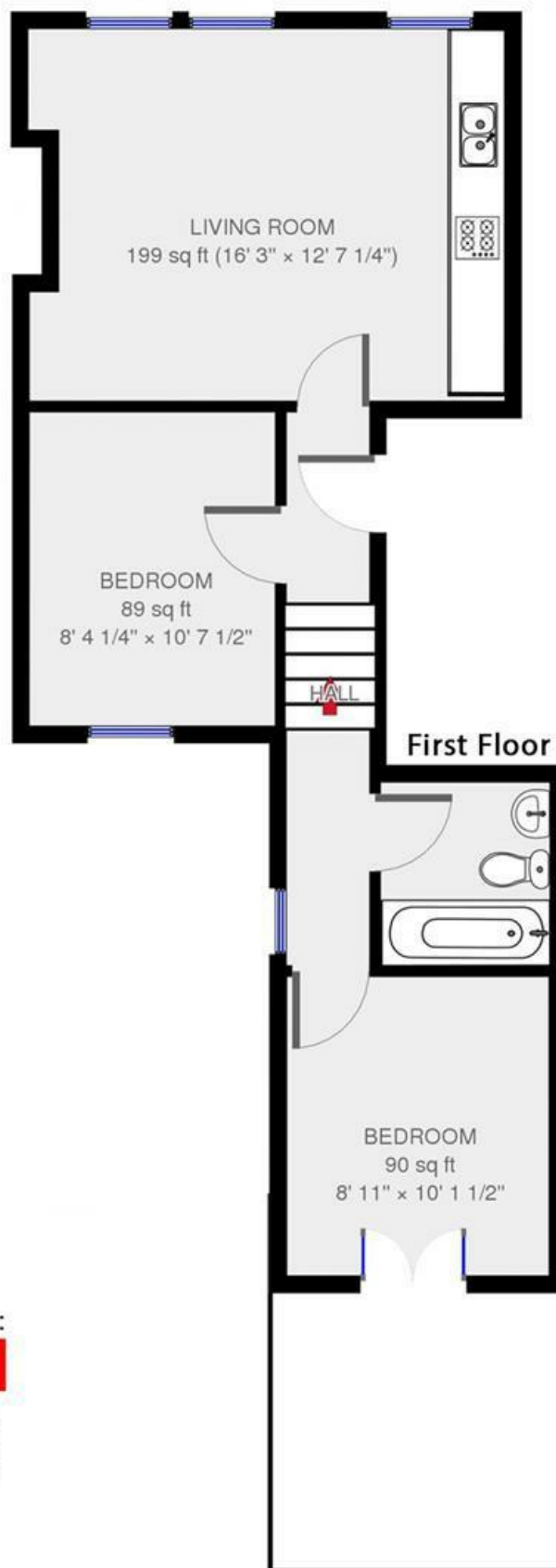

Solon Road, Brixton, SW2

